



RFM[®] DRAIN-OUT PUMP

COMPACT TRANSFER DESIGN

Pyrotek RFM[®] Drain-Out Pumps are designed to easily empty holding/melting furnaces. Each pump's compact size allows it to be transported from one vessel to another, and their reinforced fibreglass material (RFM) bowls allow for quick placement due to minimal preheat requirements.

RFM Drain-Out Pump architecture follows the technology of Pyrotek's stationary Overflow Transfer System (OTS). The pumps smoothly raise the metal from the bottom of the vessel and can drain to within three inches of the bottom.

SPECIFICATIONS

Property	RFM DRAIN-OUT PUMP
Air/Electric Motor	800AM/3HP
Bowl Metal Immersion Depth Options—mm (in)	555 (22) 700 (28) 850 (34) 1000 (40)
External Bowl Diameter—mm (in)	170 (6.70)
Flow Rate—kg/min (lb/min) at 350–700 rpm	50–365 (100–1400)
Approximate Weight—kg (lb)	100 (220)

BENEFITS

- Designed to be placed in metal quickly
- Easy graphite shaft replacement
- Eliminates the need to manually empty, tilt, or use container tapping ports
- Improves operational safety
- Increased productivity
- Low consumable expenses
- Compact and lightweight
- Practical, workable design
- Adjustable metal volume by changing motor speed
- Smooth, constant and steady metal flow
- Empties the crucible to a minimum metal level of approximately 3.0 inches
- Available with air or electric motors

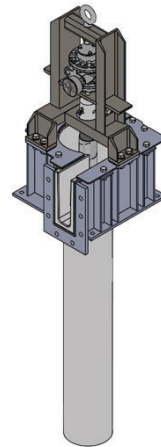

Air Motor



Electric Motor

APPLICATIONS

- Foundry and casthouse applications
- Drain holding furnaces and smaller melting furnaces
- Pumping from furnace to crucible
- Emptying a heated crucible
- Transferring to casting machines or crucibles
- Furnace-to-furnace transfers

