



# Optimize Holding Furnace Temperature and Improve Performance

## Pyrotek RFM® Thermocouple Protection Tubes

With proven aluminium expertise from the smelter to the foundry, Pyrotek offers a comprehensive range of temperature sensing elements and protection tubes. Pyrotek's RFM is a composite ceramic material that is both tough and tolerant of mechanical abuse. This fibreglass-reinforced material combined with a dense silicon-carbide tip, achieves a high-performance thermocouple protection tube.

### Benefits:

- Natural non-wetting
- Reinforced with an internal steel pipe
- High strength
- Excellent abrasion resistance

Our global network of field engineers works with aluminium producers to determine the best thermocouple, TC protection tube materials, products and designs to suit their needs.

For more information about Pyrotek temperature sensing solutions, contact your local sales engineer or visit [pyrotek.com](http://pyrotek.com).

RFM® is a registered trademark of Pyrotek Inc.  
May be covered by one or more claims in the following patents:  
EP 1522358, US 7204955, CN 100381232, JP 4681845, MX 264549



[pyrotek.com](http://pyrotek.com)

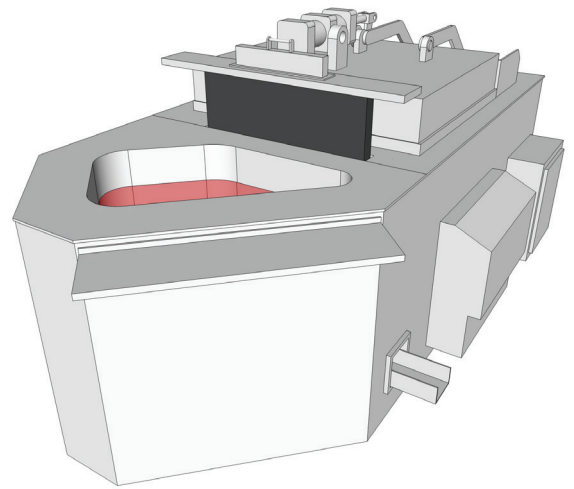

RFM PROTECTION TUBE 19 MM (3/4" NPT) PIPE FITTING		
Part Number	Outside Diameter mm (in)	Tube Length mm (in)
006757	38 (1 1/2)	305 (12)
006756	38 (1 1/2)	457 (18)
001578	38 (1 1/2)	610 (24)
006754	38 (1 1/2)	762 (30)
006753	38 (1 1/2)	914 (36)
009702	38 (1 1/2)	1067 (42)
009701	38 (1 1/2)	1219 (48)



## Why Pyrotek?

Founded in 1956, Pyrotek offers expertise in high-temperature applications with global resources and local support in more than 30 countries.

Aluminium>Foundry>Metal Holding  
MAR-17-EN-1648